

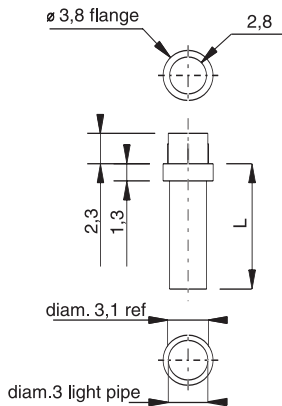

## Light Guides for front panel diam. 3mm



raccomandato mounting hole:  
 $3,05^{+0,03}_{-0,05}$

Dimensions in mm (typical)

Code	Length (L)
KPS168/032	3,2
KSP168/064	6,4
KPS168/089	8,9
KPS168/095	9,5
KPS168/127	12,7
KPS168/159	15,9
KPS168/190	19,0
KPS168/210	21,0

Hole panel: 3,05 mm 

Panel Thickness: 2,30 mm max